

# TIVERTON SQUARE

MARKHAM | ONTARIO | CANADA



OFFICE



[ricegroup.ca](http://ricegroup.ca)

# TIVERTON SQUARE

MARKHAM | ONTARIO | CANADA

OFFICE

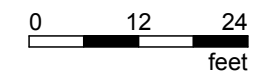
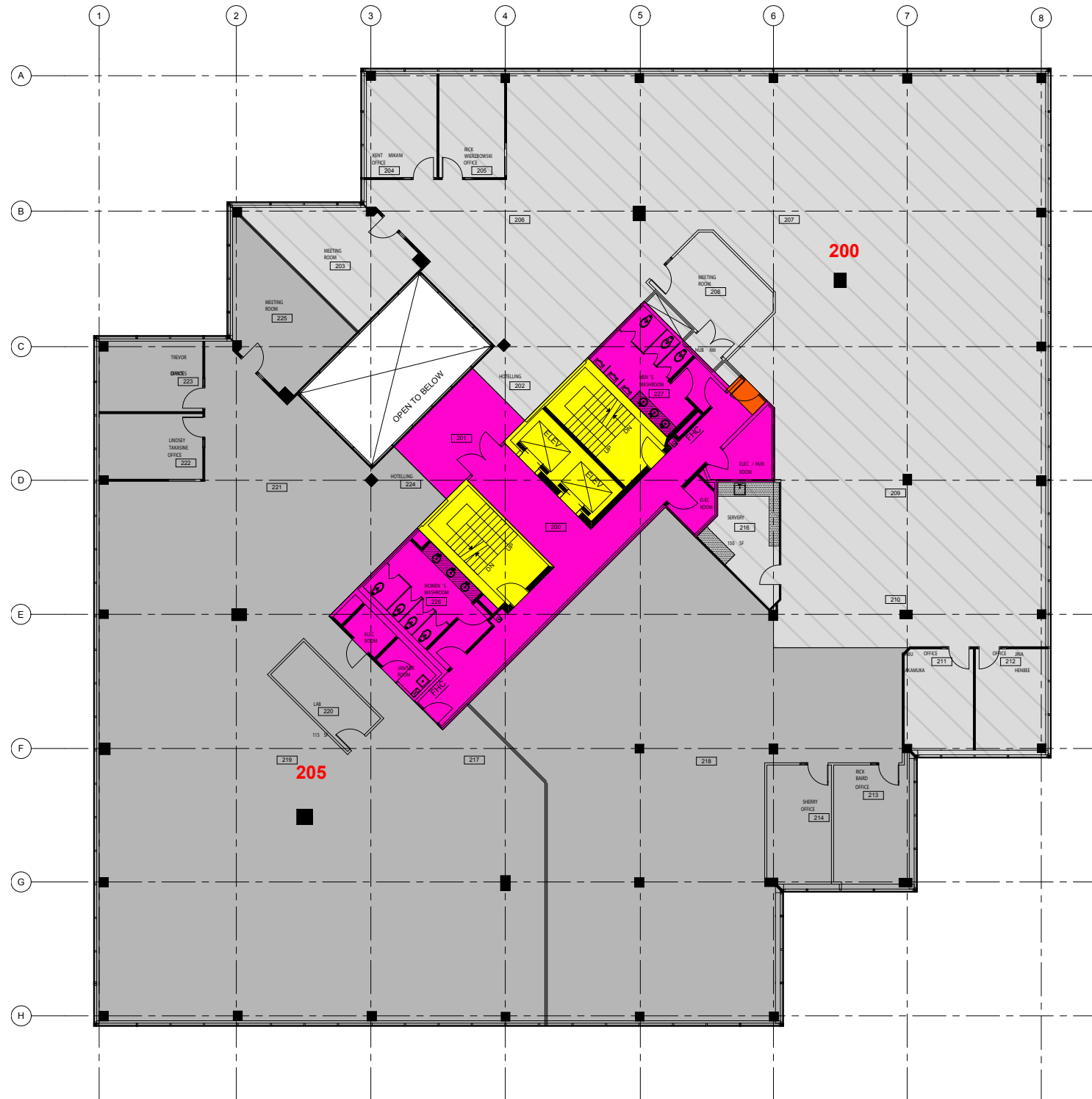



**75 TIVERTON COURT  
MARKHAM, ONTARIO L3R 4M8**



AVAILABLE SPACE  
**SECOND FLOOR  
8,161.02 SQ. FT.**



**3.8**  
/1,000 SQ. FT.



**1 TRUCK LEVEL DOOR  
1 DRIVE-IN DOOR  
WITH LEVELER**



**SPRING  
2024**

**DEMOGRAPHIC DATA**

**0-5 KM**

Total Population

**937,751**

Total Households

**316,518**

Avg. Household Income

**\$125,105**

Daytime Population

**887,437**

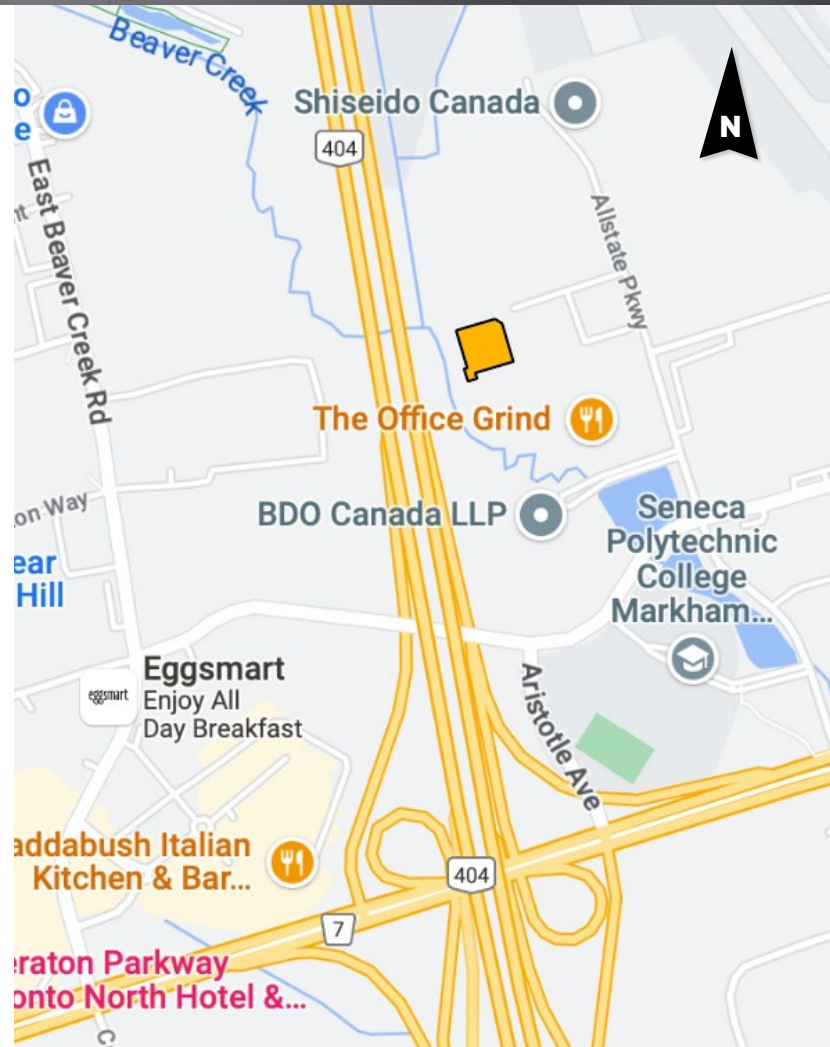

**905.888.1277 | info@ricegroup.ca | ricegroup.ca**  
75 TIVERTON CRT, MARKHAM, ONTARIO, CANADA L3R 4M8

This information is intended for informational purposes only. Rice Group does not warrant or guarantee the accuracy, correctness or completeness of the information. The recipient of this information should take such steps as deemed necessary to verify the information prior to placing any reliance upon the information contained herein.