

HIGHWAY 401 & ISLINGTON AVENUE

TORONTO | ONTARIO | CANADA



RETAIL



ricegroup.ca

HIGHWAY 401 & ISLINGTON AVENUE

TORONTO | ONTARIO | CANADA

RETAIL

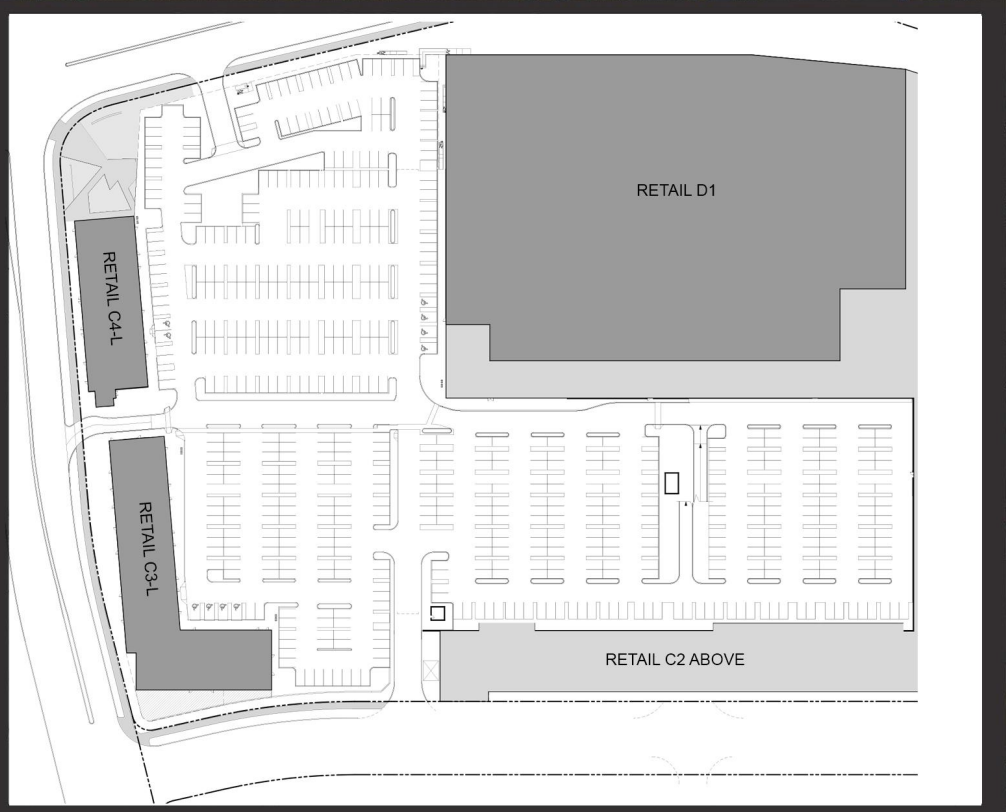
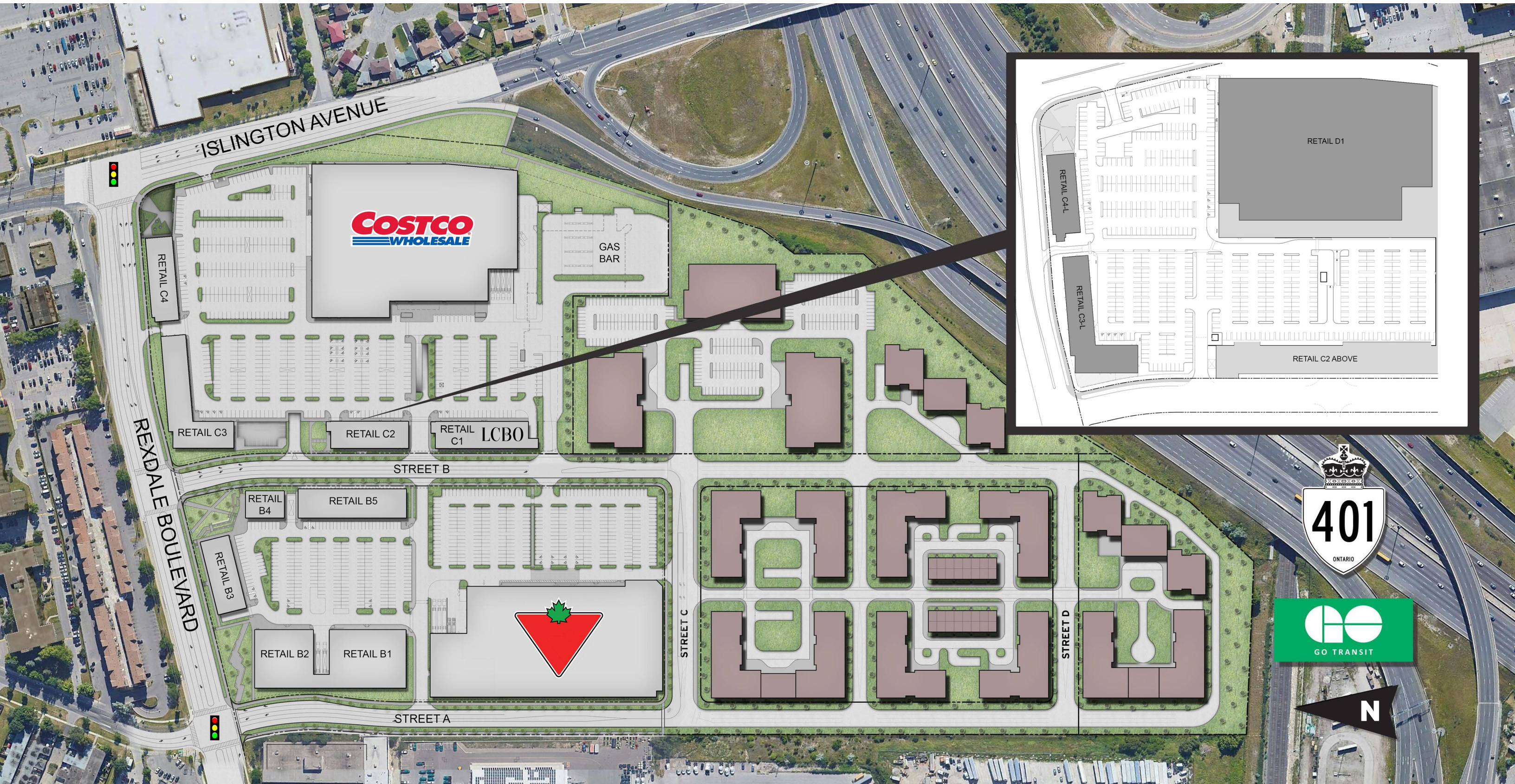

**PRIME HIGHWAY 401
RETAIL OPPORTUNITY**

The subject lands are situated on the north west corner of Highway 401 and Islington Avenue.



LAND SIZE

64.7 Acres

PROJECT SIZE

519,317 Sq. Ft.

AVAILABLE SPACE

Various unit sizes available

PARKING

3.42 / 1,000 Sq. Ft.

POSSESSION

Summer 2023

PERMITTED USES

Full retail uses

SITE FEATURES

- Anchored by Costco
- Prominent frontage onto Highway 401 and Islington Avenue
- Future direct access to GO station

KEY MAP

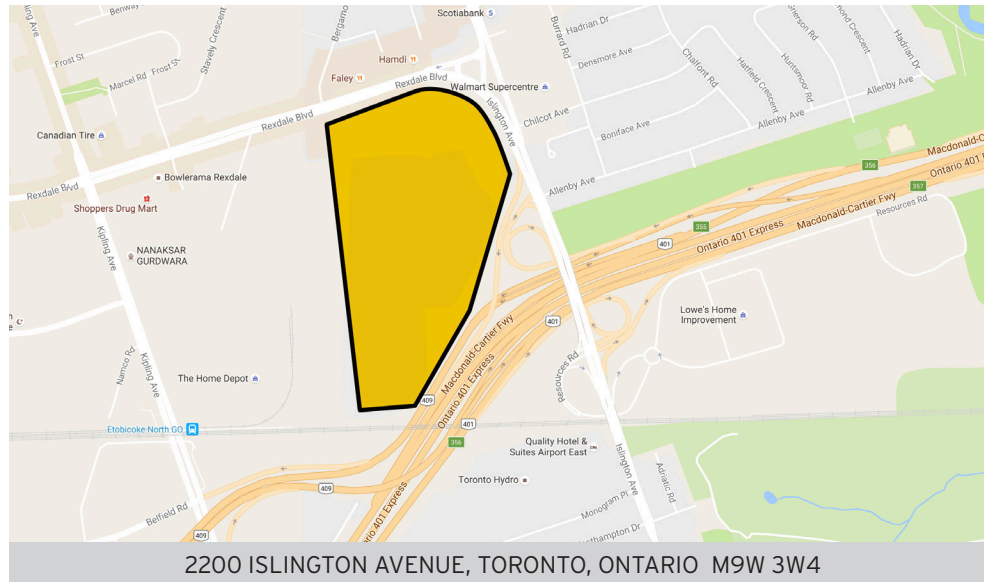

DEMOGRAPHIC DATA	0-5 KM
Total Population	259,547
Total Households	90,264
Avg. Household Income	\$99,365
Daytime Population	281,303

This information is intended for informational purposes only. Rice Group does not warrant or guarantee the accuracy, correctness or completeness of the information. The recipient of this information should take such steps as deemed necessary to verify the information prior to placing any reliance upon the information contained herein.



905.888.1277 | info@ricegroup.ca | ricegroup.ca
75 TIVERTON CRT, MARKHAM, ONTARIO, CANADA L3R 4M8